

POPULATION DEVELOPMENT IN NEW CAIRO **AREA**

Profile of the Project

The Designated community of the program:

In 1992, Cairo was hit with an unexpected earthquake that badly damaged many poor areas, since their houses were not built according to proper standards; therefore many of those families became homeless. The government eventually re-located those families into other areas to live in. Our projects designated community embraces the victims from Giza Governorate, who lost their homes and were re-located to live in the new Cairo area. That community consists of (171) buildings, each building has (20) flats, each flat hosts one family with an average of five individuals.

Therefore, our projects' designated community constitutes about 17,000 persons. Most of those families depend on the father's income which is usually minimum wage, since most of those people do not have proper education. Other families live on governmental support which is equal to LE 50 per month (equivalent to about \$10 per month).

One important sector of those people living in that area are the wives and children belonging to the families of imprisoned individuals and those who have completed their jail terms and do not have reasonable income to live on.

Most of those people are illiterate, lack knowledge about reproductive health, have health problems and have no basic vocational skills.

Our program will deal with the ladies and girls, who will be able to support the families whose guardian is either disabled, absent or unable to earn sufficient income.

The program of our project will deal with three areas of activities: literacy, reproductive health and vocational training.

Location

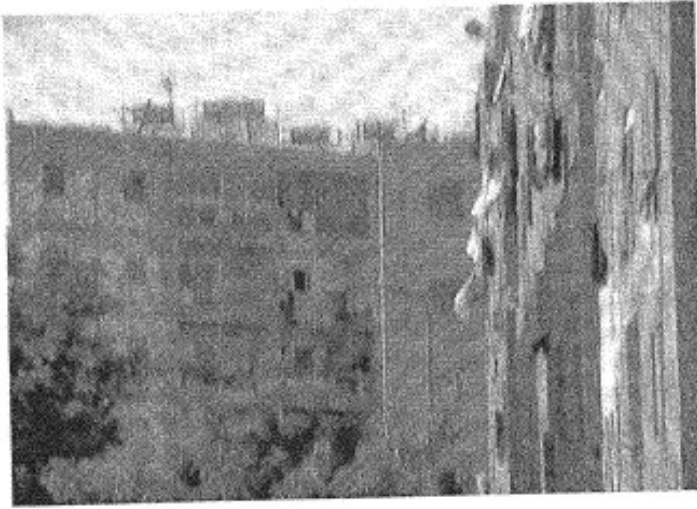

Project Description:

I- Literacy phase:

Literacy is a major obstacle in the life –path of those people, especially the younger generation.

The ultimate goal of literacy classes meets the needs of that community by providing those individuals with new opportunities in life in order to become productive citizens. It is very important to break the cycle of crime patterns within those circles through education; subsequently, by vocational training, women and girls will have the ability to develop their own business by benefiting from micro credit projects and improve their economic status.

Through such approach and education, women will have better understanding for population growth problems and will accept the ideas of proper growth control.

The program is aimed to teach 240 persons in classes using the most recent method of CLE for reading and writing. Duration of each course is 6 months (5days/week, 2hours/day). Each class will enroll 15-20 participants.

Each student attending the course successfully will be rewarded with a bonus as gift and will be provided with a certificate equivalent to basic primary education.

A special training program will be devised to prepare instructors and qualify them to run the CLE classes. Those instructors will be chosen from residents in the same area in order to assure sustainability of the program.

The host partner will assign a representative and will issue monthly reports on the progress to the international partner. The Egyptian National Rotary Committee on literacy will supervise the whole program which covers provision of qualified instructors, teaching materials and classroom spaces.

Rotarian host club members will participate in the choice of instructors and of attendants. They will deal in cooperation with the National Literacy Committee in follow –up of classes and monitoring the tests and examinations carried out periodically.

The international partner will receive the progress reports and send their comments to the host club.

Eradicating Illiteracy Program



2- Reproductive Health Project :

As a result of the improper way of living and the unawareness of the impact of uncontrolled birth on women's health , the project will arrange awareness programs for birth control and also medical convoys for proper health improvement in that community .

Health care is generally considered to be an issue of major importance in Egypt, particularly in the field of women's health. The needs of the Egyptian community are continuously increasing for the integration of the preventive birth growing presented by primary health care knowledge. Studies , in addition to practical experience , have shown the importance of introducing steps to fulfill the needs of primary health care in this field.

The impact of the project is that it solves the medical needs in the field of family planning and reproductive health with the following targets :

- 1- Reduce the mortality rate for mothers and infants .
- 2- Support the safe motherhood .
- 3- Offer child spacing methods .
- 4- Slowing down the population rate and increasing the contraceptive prevalence rate .

Rotary Club of New Cairo will issue monthly progress reports to the international partners. Assigned club members, in collaboration with the Egyptian Society for Maternity & Infantry will supervise the whole program .



3- Vocational Training phase:

The project aims to develop the potentiality of women and girls in that community. Most of those do not have any basic skills. The project is planned to teach those women and girls the basic skills of sewing using sewing machines and finishing the products in a proper saleable manner. They will be supervised by trained professionals, preferably if possible from the same community. Those women will receive salaries and also percentage of the profits to encourage higher productivity.

The product will eventually have a positive reflection on the families who will enable them to depend on themselves and share in their family's expenses. This will result in a better family relationship and an improved standard of living.

The host partner, Rotary Club of New Cairo will assign representatives to supervise the program, assure the proper quality control and will issue monthly progress reports to the international partner. A specialized committee will prepare a complete market study to identify the needs, kinds of products costs, and selling prices.

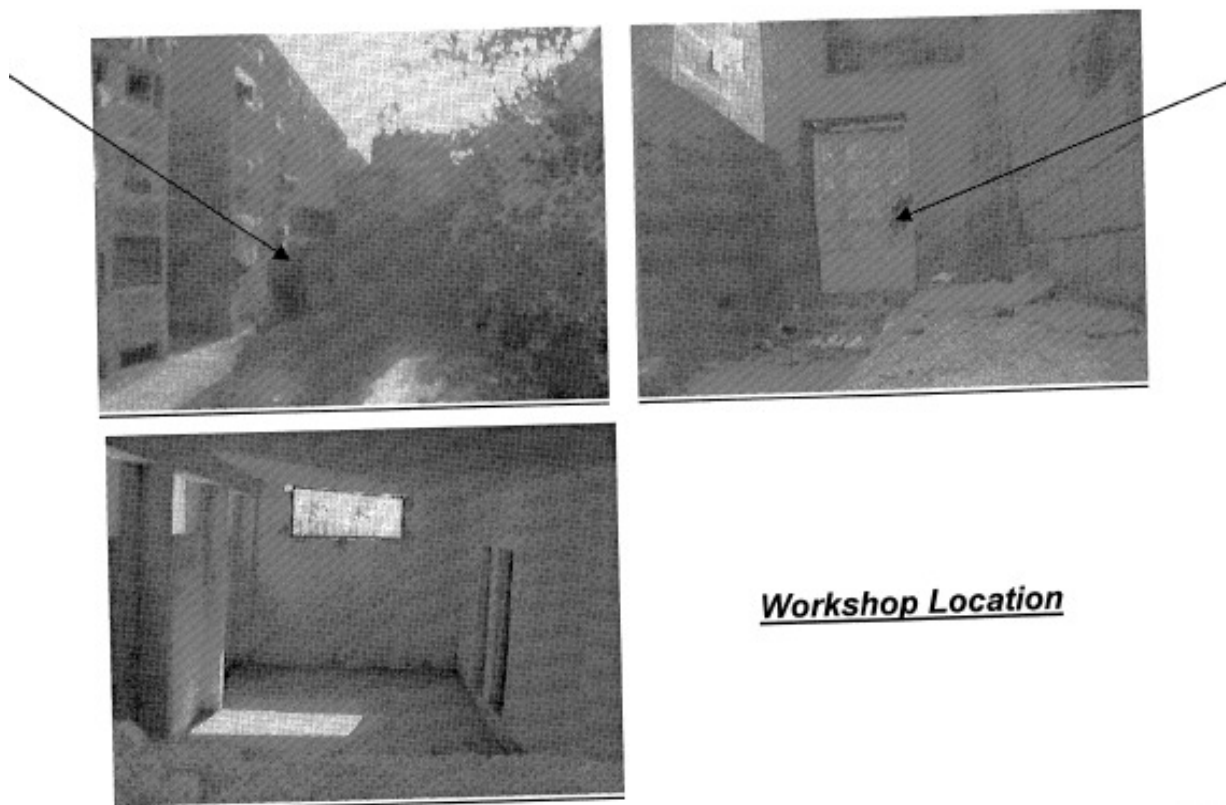

Workshop Location

